

This section of the site features the historic Railway Station building including Platform Y. The existing free camping and carpark area to the north of the station is extended and reconfigured to allow for parking and for unhooking caravans if needed. Consultation revealed the need for additional places and also the benefits of having people on site at night. Existing Poplars are retained wherever possible and or relocated. Additional trees are included for shade and also to separate camping areas.

Consultation revealed the orientation of the stage is challenging for performers and the solidity of the walls makes it difficult to see through the site. The proposal depicts the shipping container relocated and the gabions walls removed to reveal a simple concrete stage with the shade sail over. The stage is extended to the north for more flexible use. The backdrop to the stage is shown as a perforated screen to give privacy to the house next door and to create a backdrop to this creative space. Consultation with the neighbor is required. The flag pole is relocated elsewhere. A mound is created to the north of the stage for lounging and viewing. Refer to View 5 below.

Consultation revealed the path from the railway station down to the rest of the site is challenging for people with limited mobility. The path is regraded to less than 1:20 to enable equal access. This will require the removal of some sections of path, seats and lights. The path connects over to the tennis court to the proposed community garden space that is defined by a pergola with climbing plants over. The path then leads down through the site to the upgraded playground area and a possible junior pump track to the east of the playground. Consultation included the desire to include Wiradjuri inspired play elements and interpretation into the play area as well as the need for different ages of children to be catered for. Additional seating, shade trees and bike racks are shown. The existing fence around the playground is removed and instead located down on Crowley Street with gate openings to define the park as a destination. The existing basketball hoop is transformed into an additional BarBQ and picnic table area.

The existing concrete path through the site is the low point. It is removed and reimaged into a shallow grassed swale to collect overland flow and send it to stormwater on Crowley Street.

Platform Y have noted they may in the future open a coffee window to the existing building. Painted road and bollards define the pedestrian space that could enable this. This path then leads down to the Gidginbung information centre for people to learn of the history of the site. The path then leads on to a shelter and BarBQ and picnic tables. Bike parking and E or standard Bike hire could be located at this hub. The path continues past raised garden plots that feature crops or flowering plants as display gardens by gardening groups, schools, community groups or individuals.

Platform Y have noted their intention of creating a community garden on the old tennis court. The shipping container from the stage is relocated for the storage of tools, the creation of a window to sell fruit and veggies and to act as a community notice board.



Community Garden



View 5 The Stage
Refer to L08 for expanded view
Image of screen by Rick Vermey

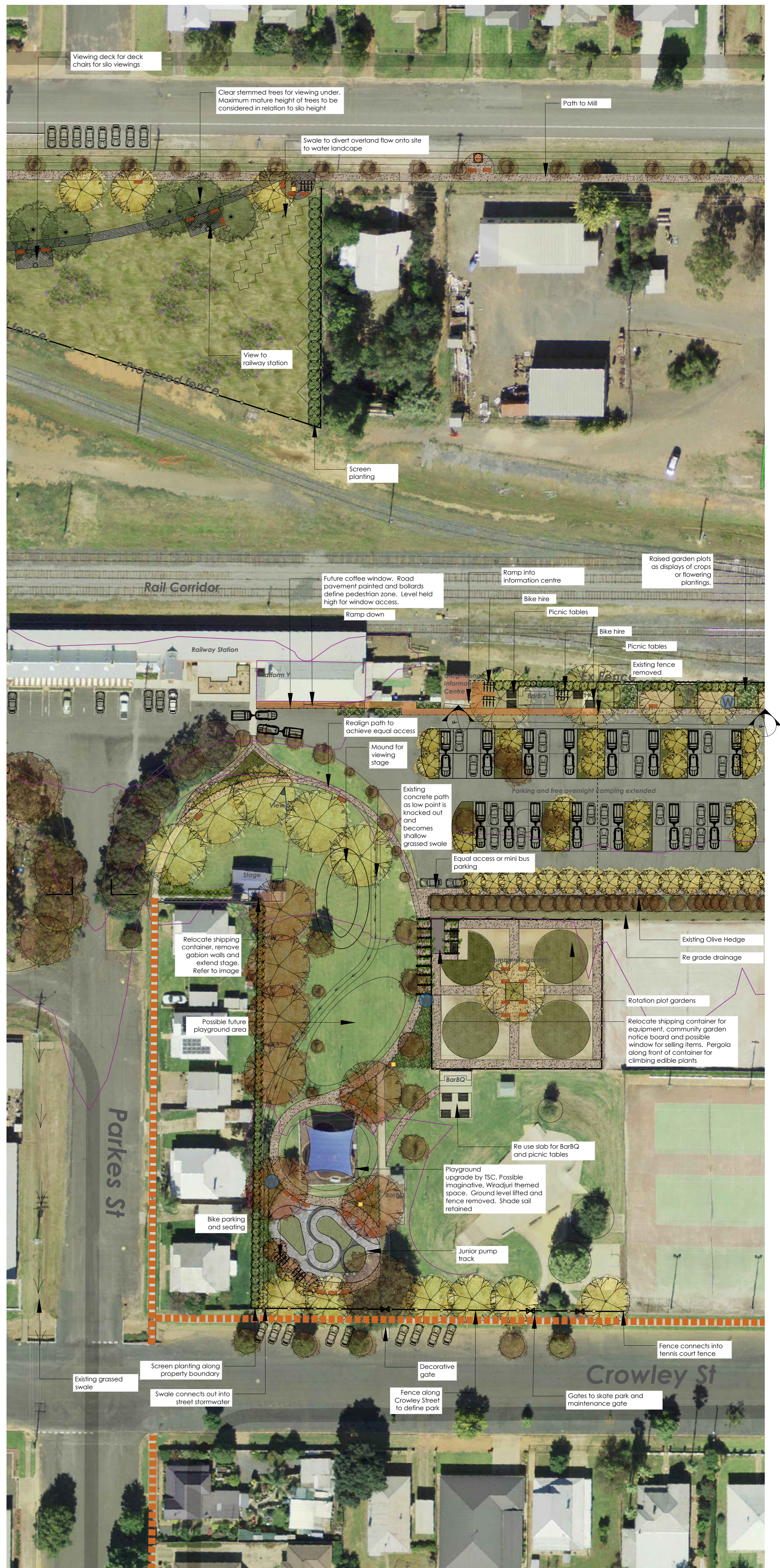

NOTES
It is assumed that all land associated with the railway is contaminated. It is understood that any work associated with these areas will need further testing and remediation prior to works commencing any work.

All stormwater works as shown will require further testing as an overall stormwater strategy. It is the hope that the masterplan provides guidance of additional retention in wet times and the inclusion of water sensitive urban design to better use water through the landscape in dry times.

It is understood that all land including road crossings under the control of TNSW and managed by UGLRL will require further consultation and detail. It is understood that any projections onto sites are not yet approved and require consideration.

Somewhere.

LANDSCAPE ARCHITECTS, DESIGNERS AND DREAMERS

Temora Railway Precinct
Temora
Wiradjuri Country

CLIENT Temora Shire Council
DATE 10.08.23
PROJECT J727

SCALE 1:500
REVISION B
STATUS For Comment

